

B1 SITE DEMOLITION PLAN
SCALE: 1" = 10'

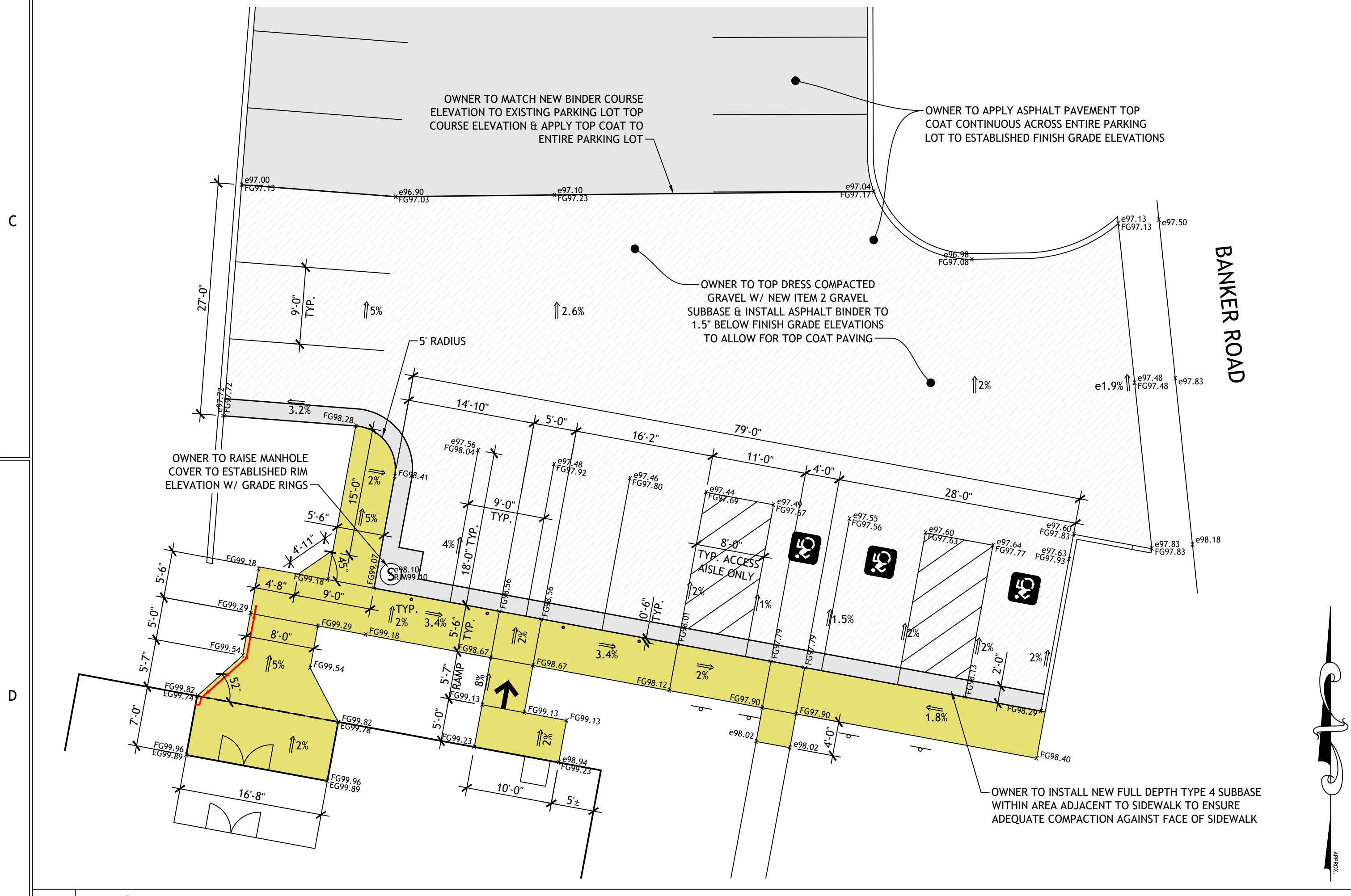

D1 LAYOUT PLAN
SCALE: 1" = 10'

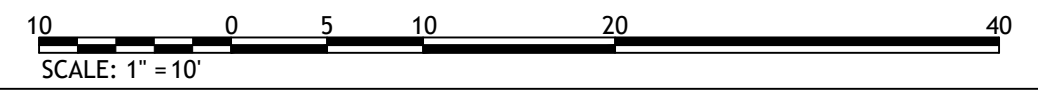
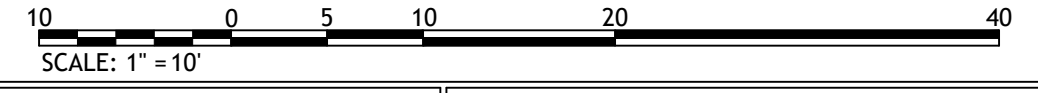

LEGEND

- SPOT GRADE ELEVATIONS
- SURFACE SLOPE DIRECTION & PITCH
- EXISTING / NEW MANHOLE
- EXISTING / NEW WELL
- EXISTING / NEW MANHOLE
- EXISTING / NEW UTILITY POLE
- EXISTING / NEW FIRE HYDRANT
- EXISTING / NEW WATER CURB STOP
- EXISTING / NEW EASEMENT BOUNDARY
- BUILDING SETBACKS
- EXISTING / NEW TREE LINE
- PROPERTY LINE ABUTTERS
- EXISTING / NEW PROPERTY LINE
- EXISTING / NEW DITCH CENTERLINE
- EXISTING GRADE CONTOUR
- FINISHED GRADE CONTOUR
- EXISTING / NEW STORM DRAIN
- EXISTING / NEW WATER SERVICE
- EXISTING / NEW SEWER SERVICE
- EXISTING / NEW GAS MAIN
- EXISTING / NEW UNDERGROUND UTILITIES
- EXISTING / NEW OVERHEAD UTILITIES
- EXISTING / NEW BUILDING
- EXISTING / NEW CONCRETE CURB (FULL / FLUSH)
- EXISTING / NEW CONCRETE SIDEWALK / PAD
- EXISTING / NEW PAVEMENT
- EXISTING / NEW GRAVEL

PARCEL OWNER:
TOWN OF PLATTSBURGH
151 BANKER ROAD
PLATTSBURGH, NY 12091

PROPOSED PROJECT:
BUILDING ACCESS IMPROVEMENTS TO MEET ADA ACCESSIBILITY REQUIREMENTS INCLUDING BUT NOT LIMITED TO CURB & SIDEWALK REPLACEMENT, NEW SIGNAGE & RE-STRIPING OF PARKING LOTS.

PROJECT PARCEL:
TAX MAP ID 205.-2-9

ACCESSIBLE ROUTE NOTE:
IT IS THE INTENT OF THE PROJECT THAT ALL SIDEWALK IMPROVEMENTS (HATCHED IN YELLOW) WILL CONFORM TO ADA STANDARDS IN PROVIDING AN ACCESSIBLE ROUTE TO THE NORTH BUILDING ENTRANCE AND TAX & WATER PAYMENT WINDOW. ADJUSTMENTS TO PAVEMENT (HATCHED IN GRAY) ARE ALSO INTENDED TO ACHIEVE ADA COMPLIANCE AT SIDEWALK ACCESS LOCATIONS.

WORK SCOPE & SEQUENCING NOTES:

- BY OWNER:
 - ALL EXTERIOR DEMOLITION AS SHOWN ON DEMOLITION PLAN HEREIN ALONG WITH GRAVEL SUBBASE PREP, COMPACTION & SUBGRADE ELEVATION ESTABLISHMENT TO BE PERFORMED BY THE OWNER PRIOR TO NEW CONSTRUCTION BY THE CONTRACTOR.
 - WORK AS SHOWN ON SITE LAYOUT & OVERVIEW PLAN HEREIN TO BE PERFORMED BY THE OWNER UPON COMPLETION OF CONCRETE WORK BY CONTRACTOR INCLUDING BUT NOT LIMITED TO THE FOLLOWING:
 - MINOR FINE GRADING OF SUBBASE MATERIAL & INSTALLATION OF NEW ASPHALT BINDER
 - NEW TOP ASPHALT PAVEMENT COAT TO ENTIRE PARKING LOT
 - MANHOLE STRUCTURE COVER RAISING TO FINISH RIM ELEVATION
 - ESTABLISHMENT & STABILIZATION OF NEW PLANTING BED
 - FURNISH & INSTALLATION OF ACCESSIBLE PARKING SIGNS
- BY CONTRACTOR:
 - THE FOLLOWING WORK AS SHOWN ON LAYOUT PLAN HEREIN IS TO BE PERFORMED BY THE CONTRACTOR:
 - FORM & POUR NEW CONCRETE SIDEWALK, FURNISH & INSTALLATION OF NEW BOLLARDS & HAND RAILING

PLAN REFERENCE NOTE

THIS PLAN IS INTENDED FOR GENERAL REPRESENTATION OF THE EXISTING CONDITIONS AND SITE IMPROVEMENTS AND SHALL NOT BE CONSTRUED AS A PROPERTY OR FIELD SURVEY. BACKGROUND INFORMATION HAS BEEN DEVELOPED FROM HISTORICAL PROPERTY INFORMATION AND CASUAL FIELD OBSERVATIONS & MEASUREMENTS AS PERFORMED BY AEDA, P.C., AND THE FOLLOWING PLAN REFERENCES:

- TOWN OF PLATTSBURGH GARAGE & OFFICE BUILDING ADDITION, AS PREPARED BY AEDA, P.C., DATED 08/1989

PARKING SCHEDULE

PARKING LOT	EXISTING # OF SPACES
UPPER NORTH	35
LOWER NORTH	15
SOUTH	77
TOTAL =	127
TOTAL REQUIRED ACCESSIBLE SPACES =	5
TOTAL ADDITIONAL ACCESSIBLE SPACES =	1

PARKING NOTES:

- ACCESSIBLE PARKING SPACES ARE REQUIRED AT A RATE OF 1 ACCESSIBLE SPACE PER EVERY 25 TOTAL PARKING SPACES IN ACCORDANCE WITH TABLE 208.2 OF THE ADA STANDARDS FOR ACCESSIBLE DESIGN.
- TWO (2) EXISTING ACCESSIBLE PARKING SPACES LOCATED WITHIN SOUTH PARKING LOT TO REMAIN FOR ACCESSIBLE ENTRY INTO BUILDING SOUTHERN ENTRANCE.
- BOTH THE NORTHERN & SOUTHERN PARKING LOTS TO BE RE-STRIPED WITH 9'x18' STALLS & ACCESS AISLES.

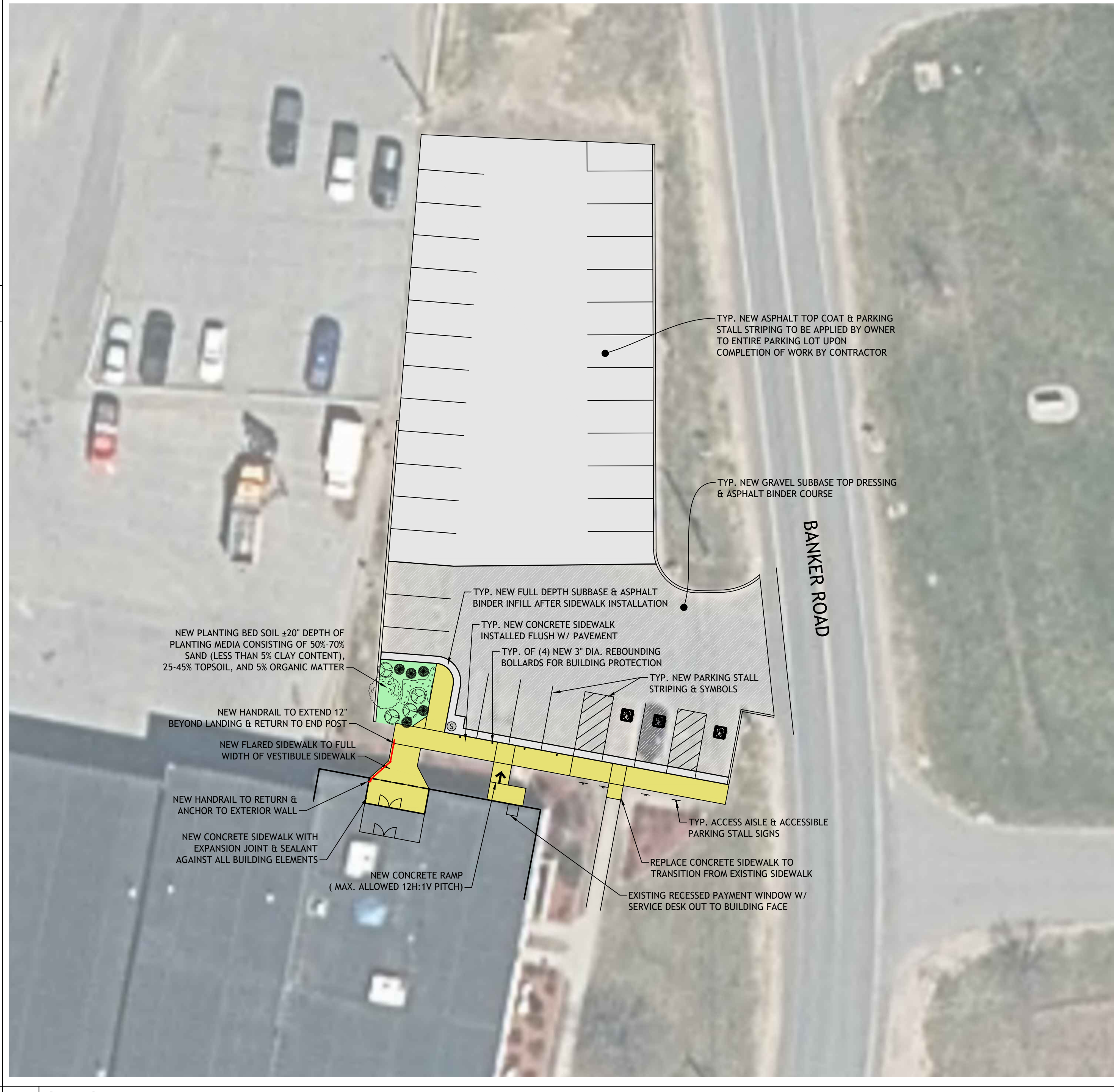

D3 SITE OVERVIEW PLAN
SCALE: 1" = 20'

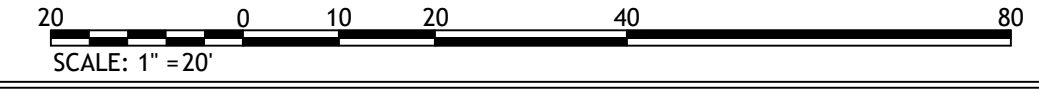

ARCHITECTURAL & ENGINEERING DESIGN ASSOCIATES, P.C.
1246 RT. 3 - P.O. BOX 762
PLATTSBURGH, NEW YORK, 12091
T: 518.562.1800
F: 518.562.1702
E: JAH@AEDAPC.COM

COPYRIGHT © ARCHITECTURAL & ENGINEERING DESIGN ASSOCIATES, P.C. HAS THE EXCLUSIVE RIGHT TO REPRODUCE THE WORK, TO MAKE DERIVATIVE USE OF IT, TO GRANT LICENSES TO USE THE WORK, TO SELL THE WORK AND TO OTHERWISE DEAL WITH THE COPYRIGHT THROUGHOUT THE LIFE OF THE COPYRIGHT OWNER AND FOR 90 YEARS BEYOND (UNLESS NOTED OTHERWISE) - UNAUTHORIZED ALTERATIONS AND/OR ADDITIONS TO THIS DRAWING BEARING A LICENSED ARCHITECT'S OR ENGINEER'S SEAL IS A VIOLATION OF SECTION 2209, SUBDIVISION 2, OF THE NEW YORK STATE EDUCATION LAW. ONLY COPIES FROM THE ORIGINAL OF THIS DRAWING BEARING THE ORIGINAL ARCHITECT'S OR ENGINEER'S SEAL AND SIGNATURE SHALL BE CONSIDERED VALID TRUE COPIES.

**TOWN OF PLATTSBURGH - TOWN HALL
NORTH ENTRANCE EXTERIOR IMPROVEMENTS**

151 BANKER ROAD, TOWN OF PLATTSBURGH, NEW YORK 12091

**CONSTRUCTION DOCUMENT
PHASE
SERVICES 100%**



REVISIONS

#	BY	DATE

SITE PLAN

PROJECT NO. 23025-001
DATE 03-07-25
DRAWN BY DLL
CHECKED BY MSC

C101

REVISIONS		
#	BY	DATE

SITE DETAILS

PROJECT NO. 23025-001
DATE 03-07-25
DRAWN BY DLL
CHECKED BY MSC

C501

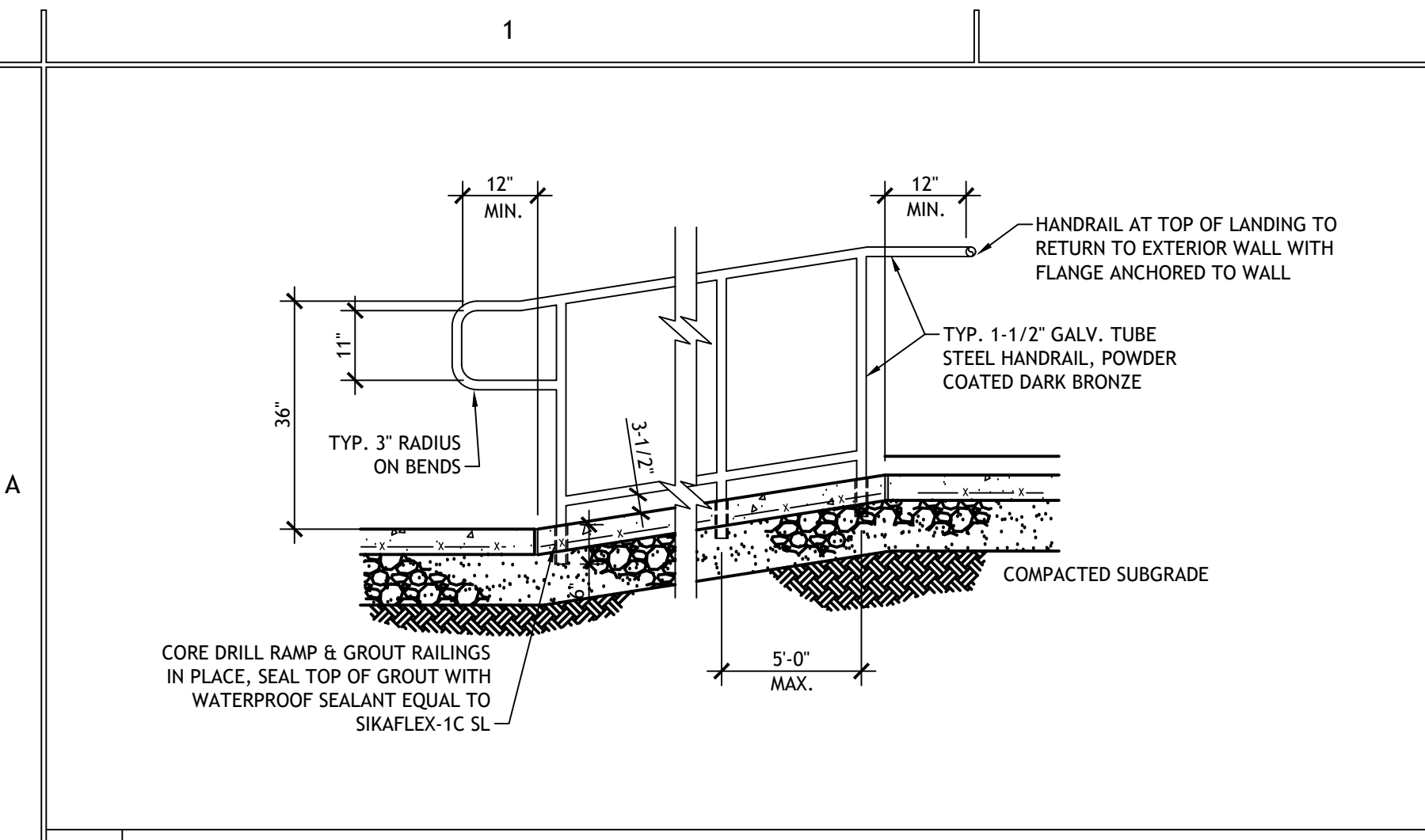

A1 TYP. HAND RAILING ASSEMBLY (BY CONTRACTOR)
SCALE: N.T.S.

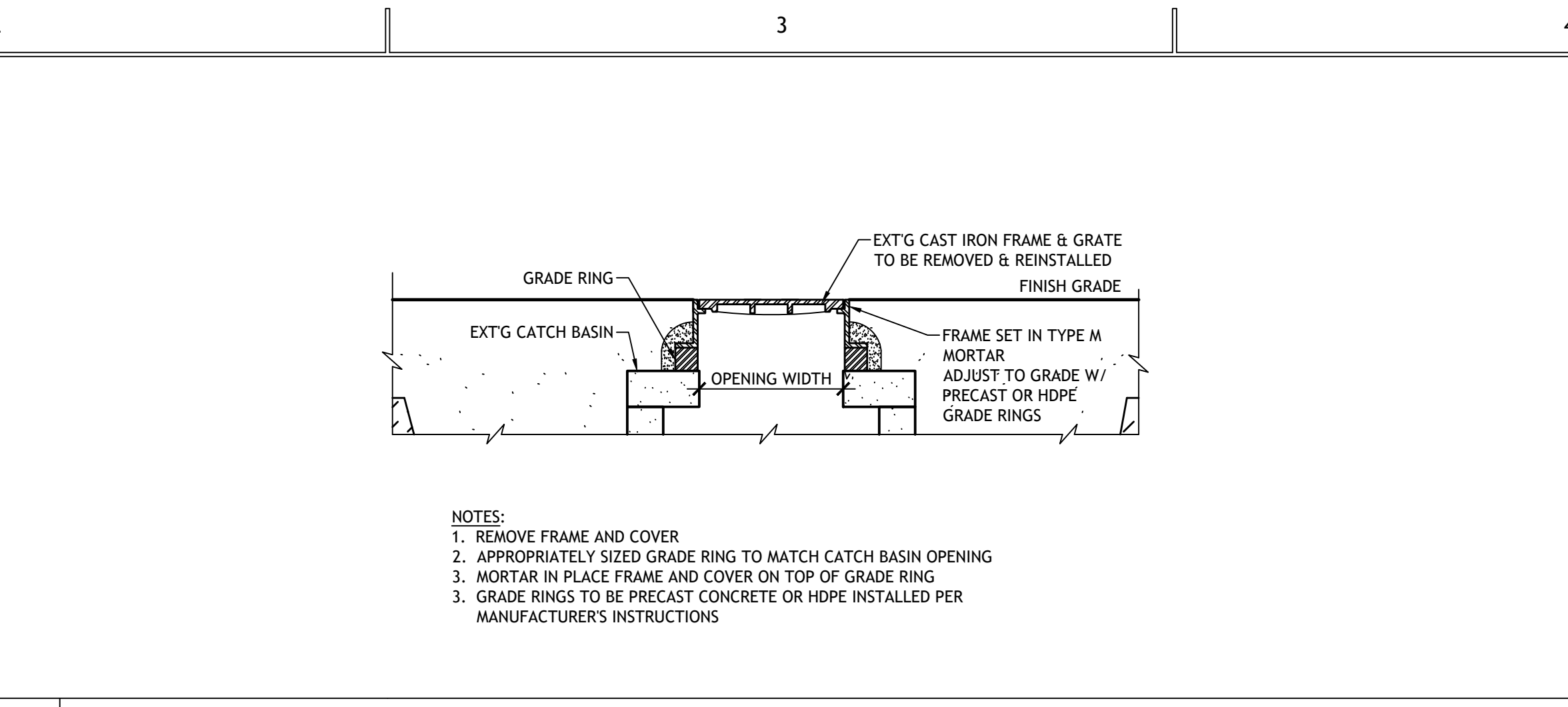

A2 FRAME HEIGHT ADJUSTMENT W/ GRADE RING (BY OWNER)
SCALE: N.T.S.

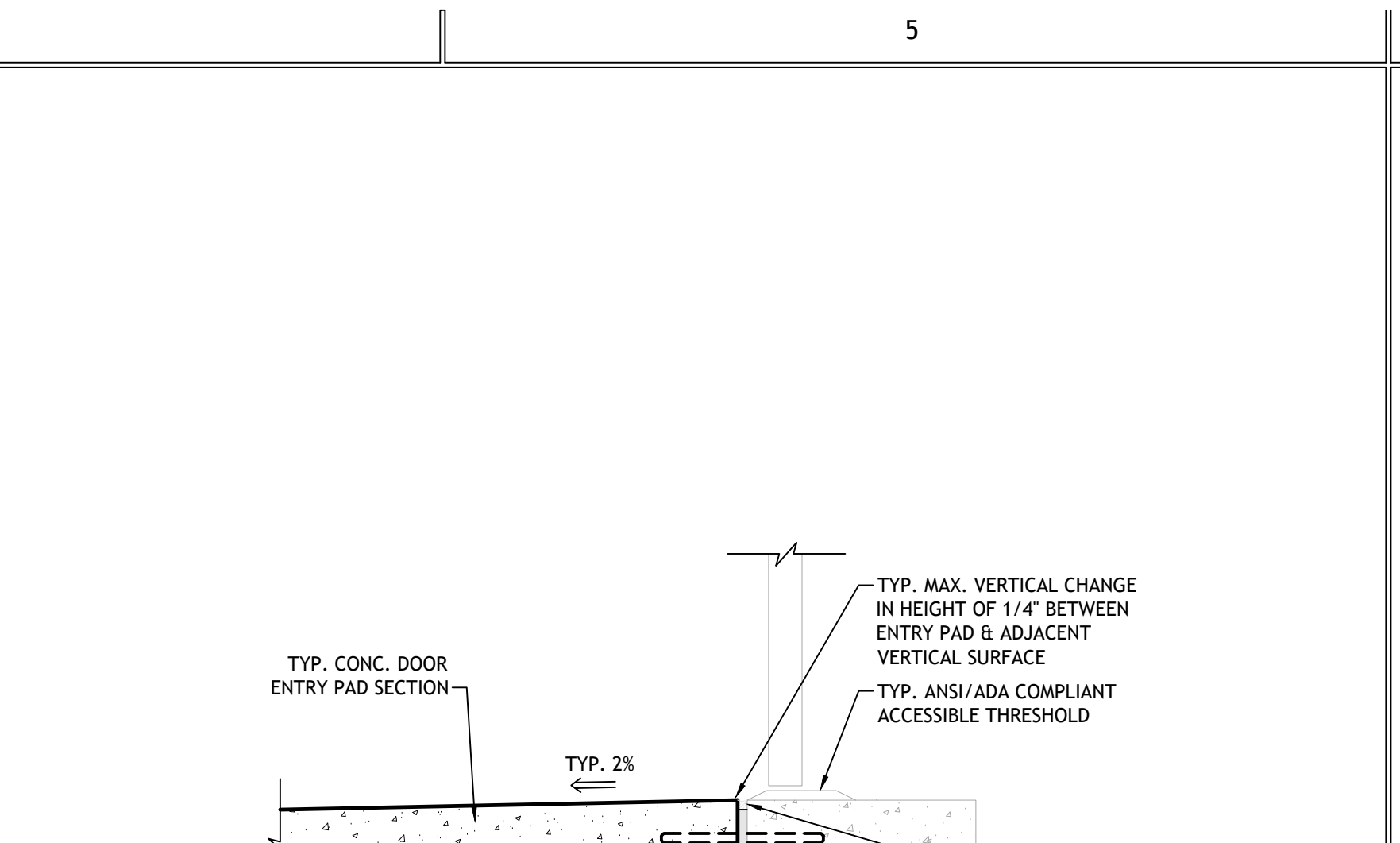

B4 TYP. ACCESSIBLE ENTRY DETAIL (BY CONTRACTOR)
SCALE: N.T.S.

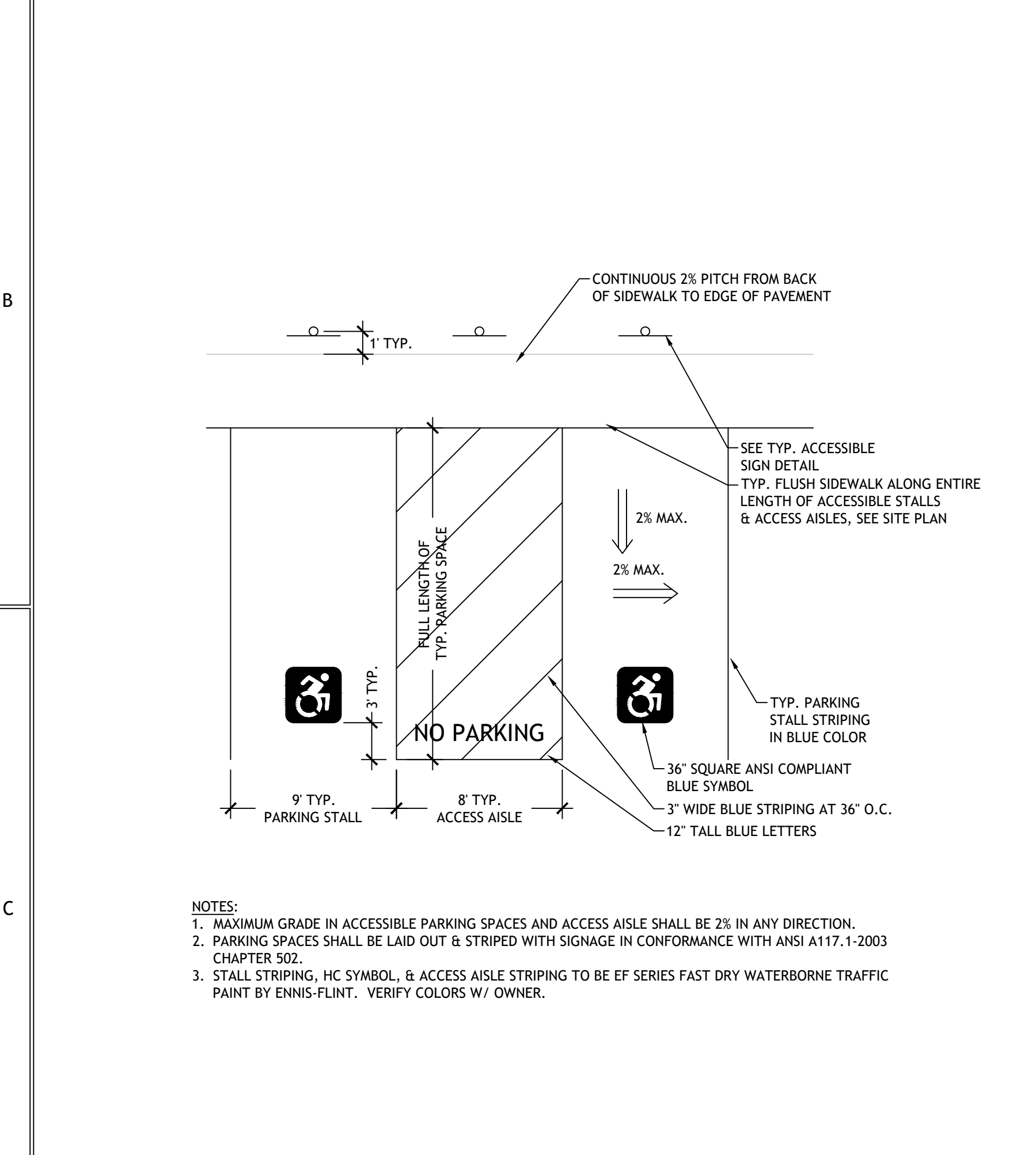

C1 TYP. ACCESSIBLE PARKING SPACE DETAIL (BY OWNER)
SCALE: N.T.S.

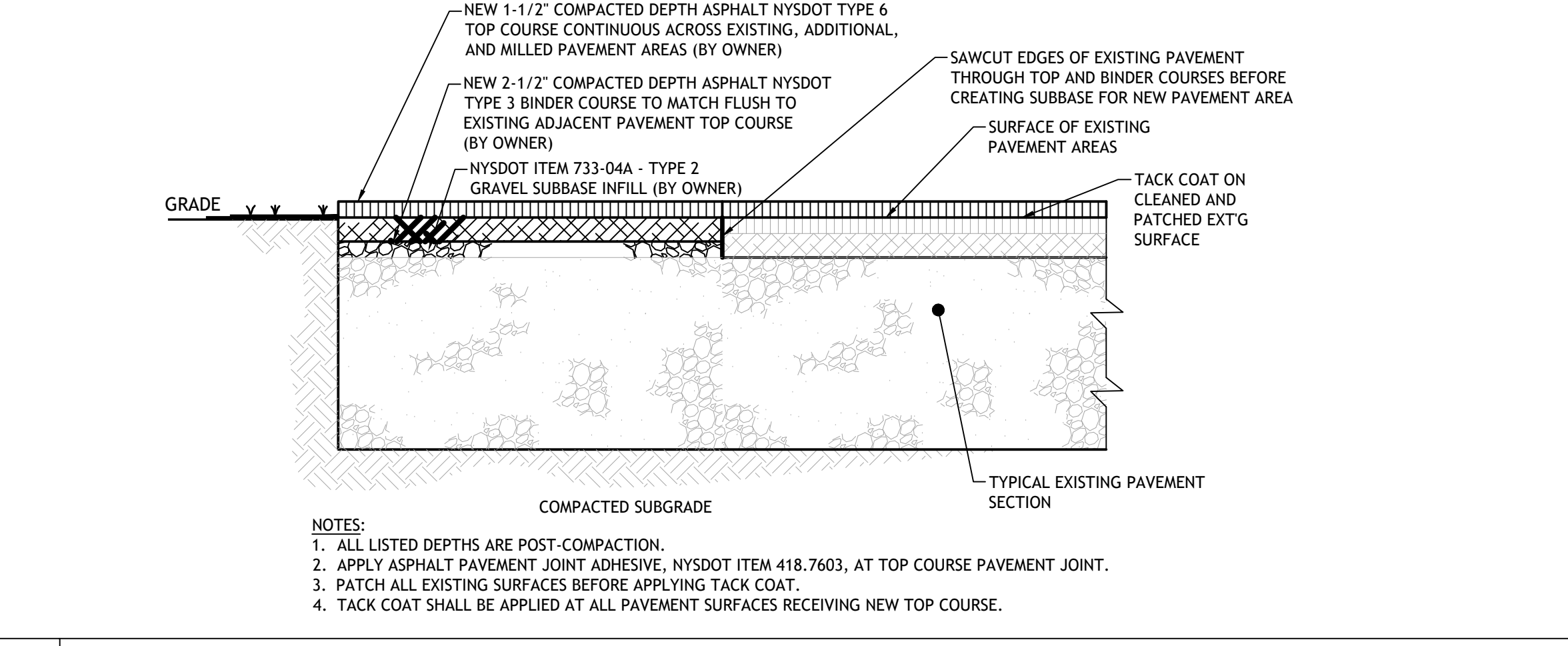

B2 TYP. NEW PAVEMENT AGAINST EXISTING PAVEMENT SECTION (BY OWNER)
SCALE: N.T.S.

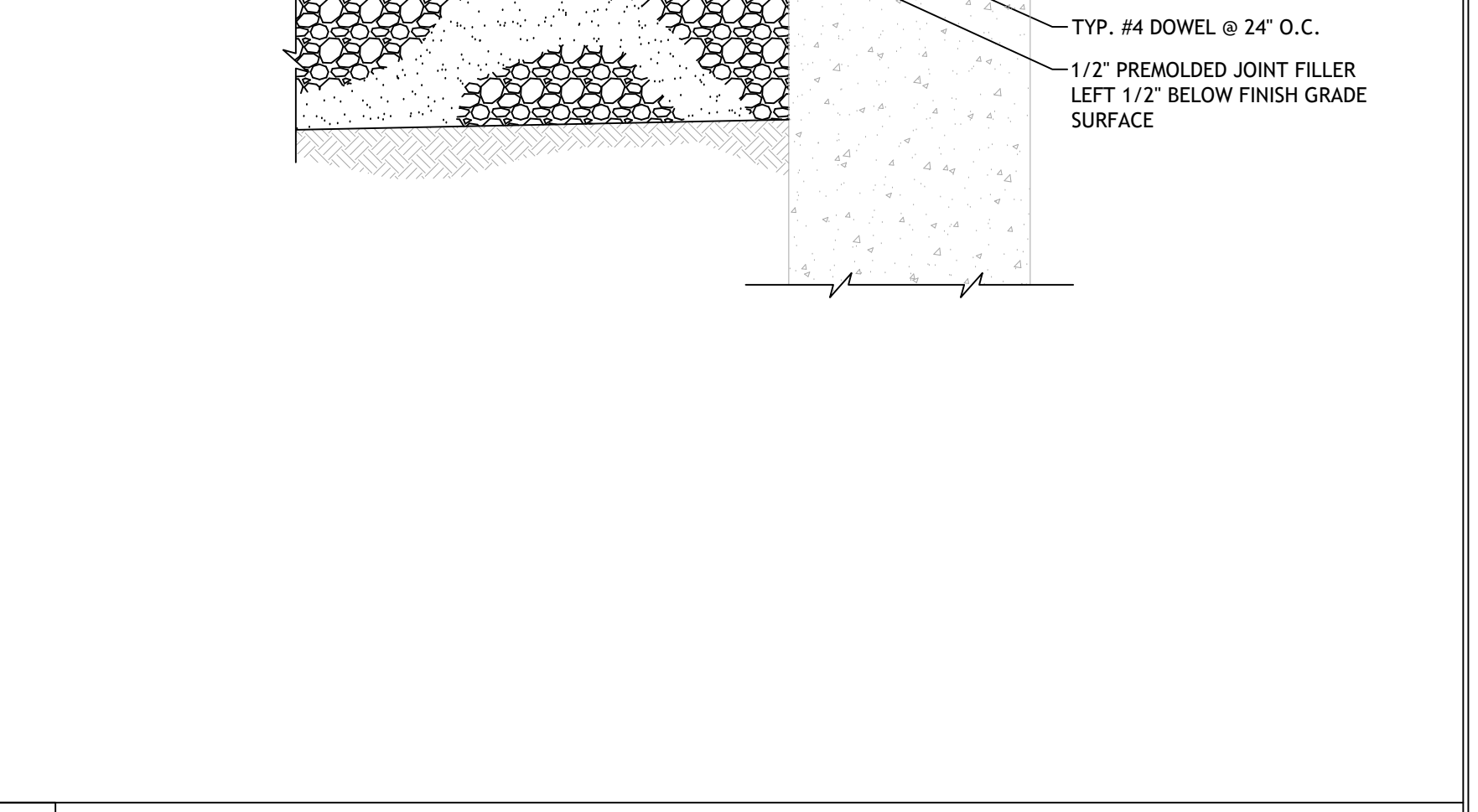

B4 TYP. ACCESSIBLE ENTRY DETAIL (BY CONTRACTOR)
SCALE: N.T.S.

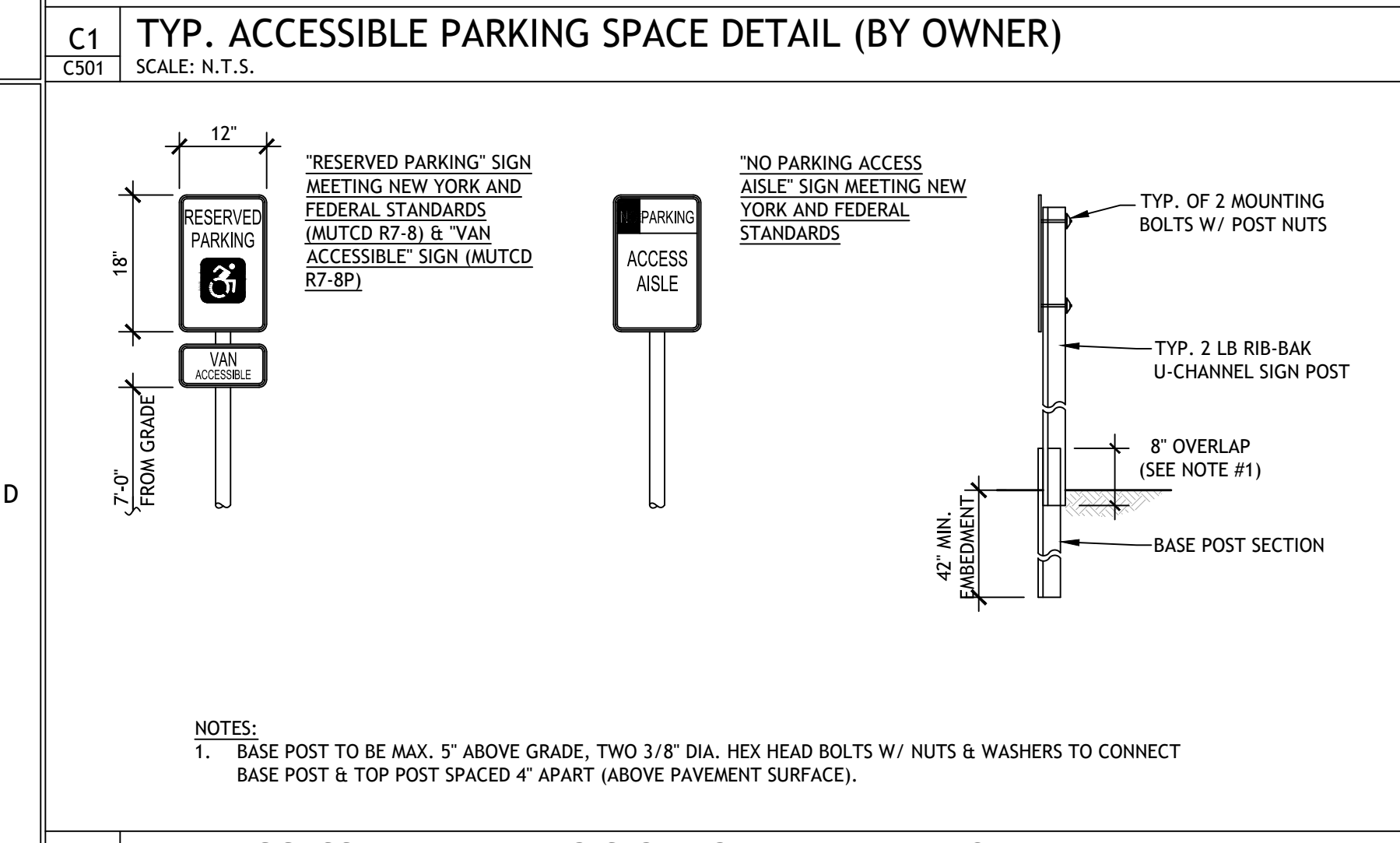

C1 TYP. ACCESSIBLE PARKING SIGNAGE DETAIL (BY OWNER)
SCALE: N.T.S.

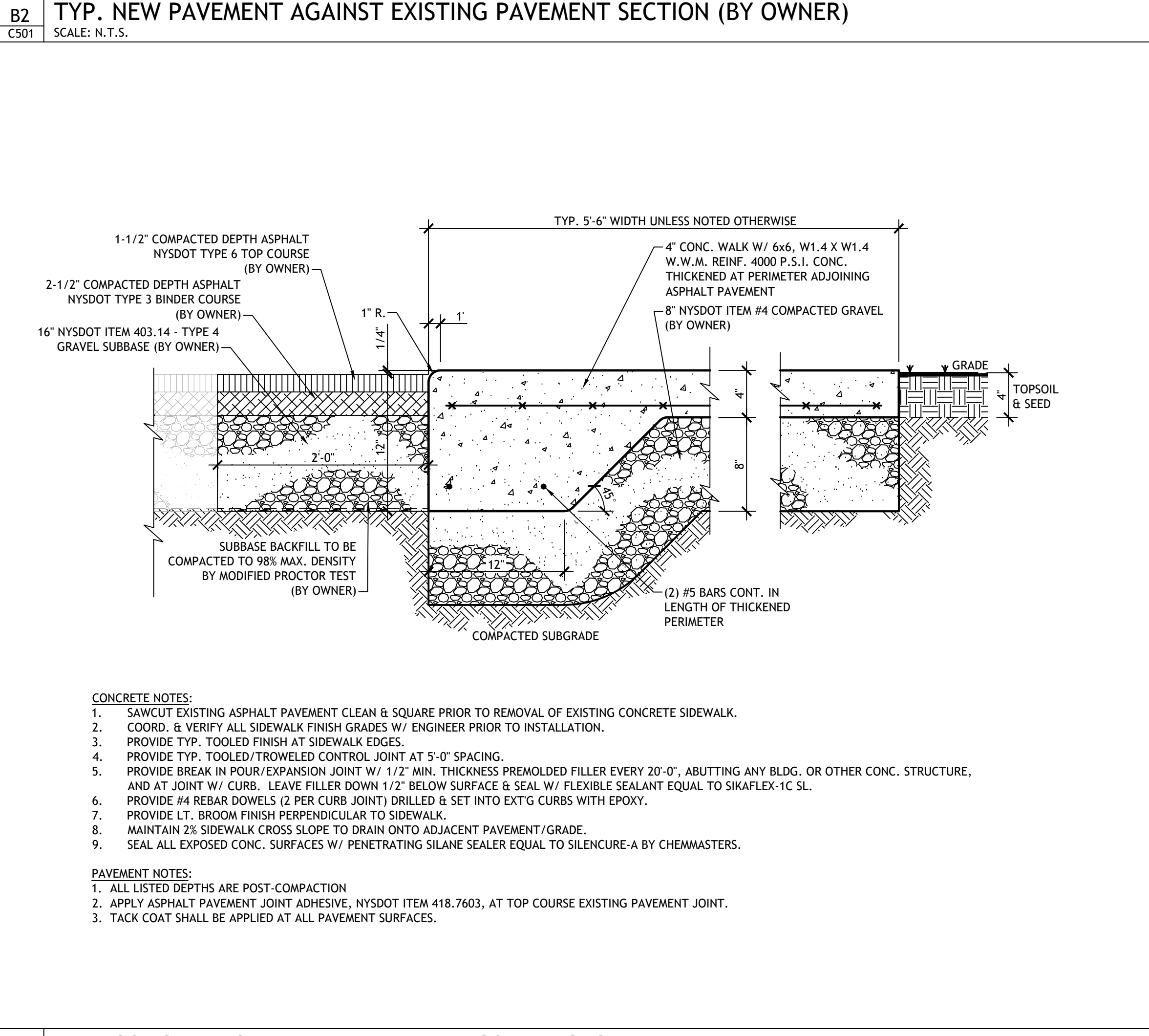

D2 TYP. CONCRETE SIDEWALK DETAIL (BY CONTRACTOR)
SCALE: N.T.S.

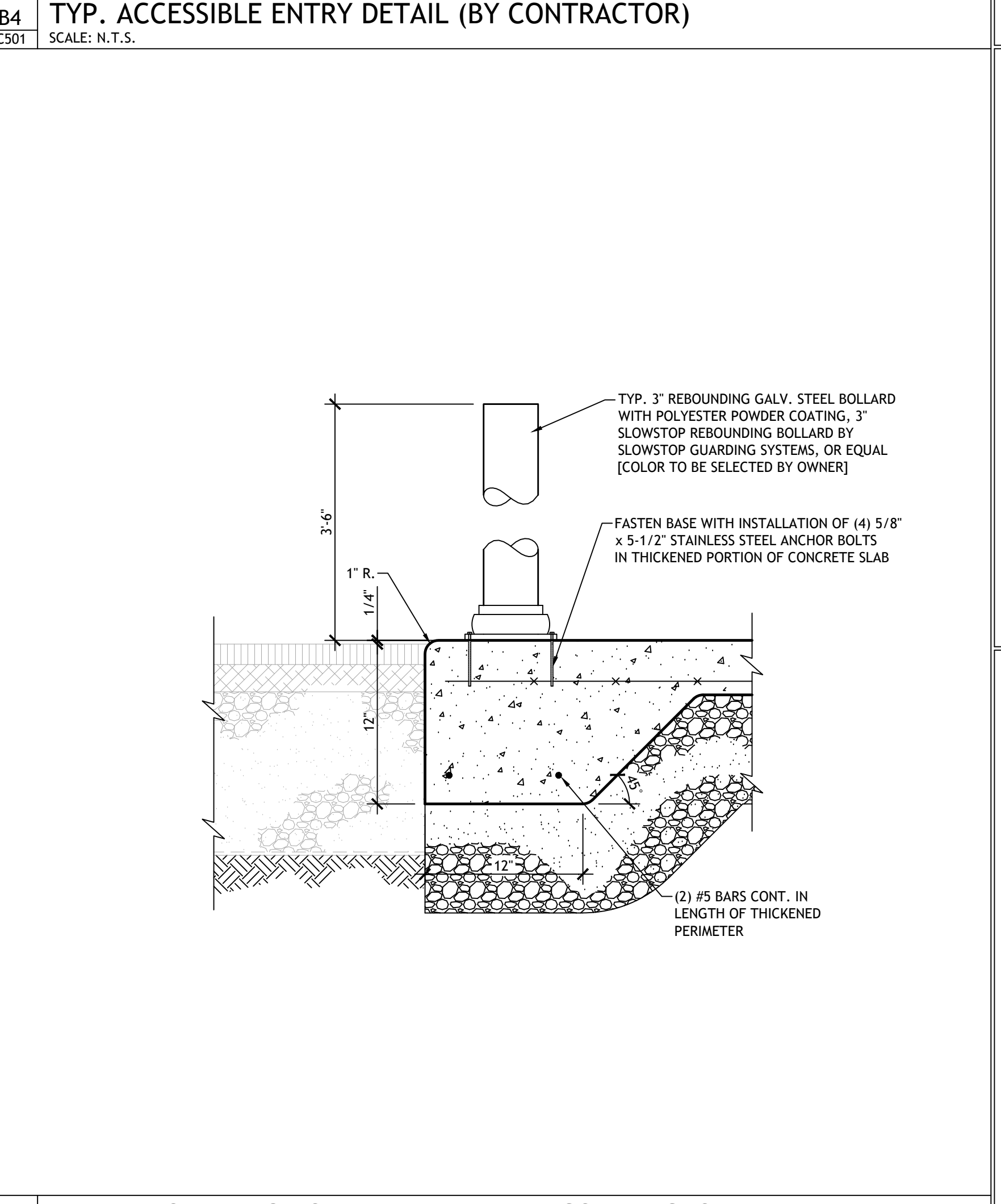

D4 TYP. REBOUNDING BOLLARD DETAIL (BY CONTRACTOR)
SCALE: N.T.S.